

PARTS LIST			
ITEM	QTY	PART NUMBER	DESCRIPTION
1	2	0486-7313522-1	ALUMINIUM HINGE BODY - RH
2	10	0486-7313522-2	ALUMINIUM DOUBLE KNUCKLE
3	2	0486-7313522-3	S/STEEL 304 HINGE PIN

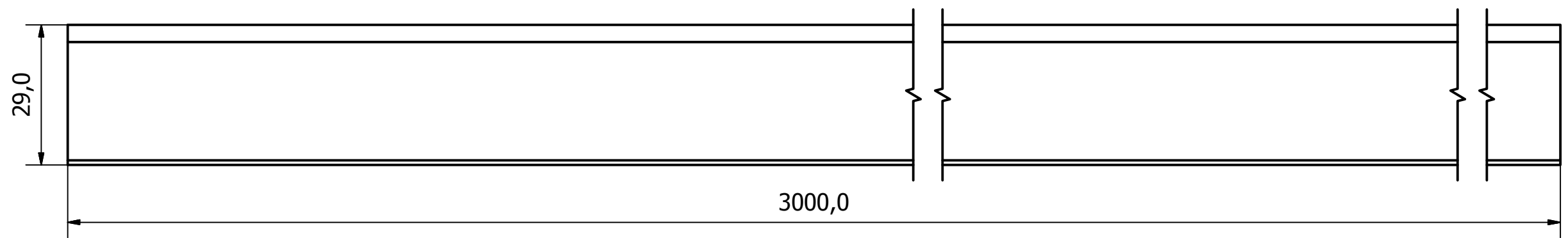
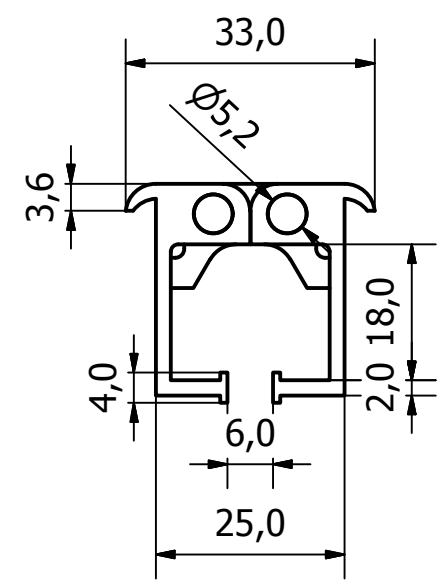
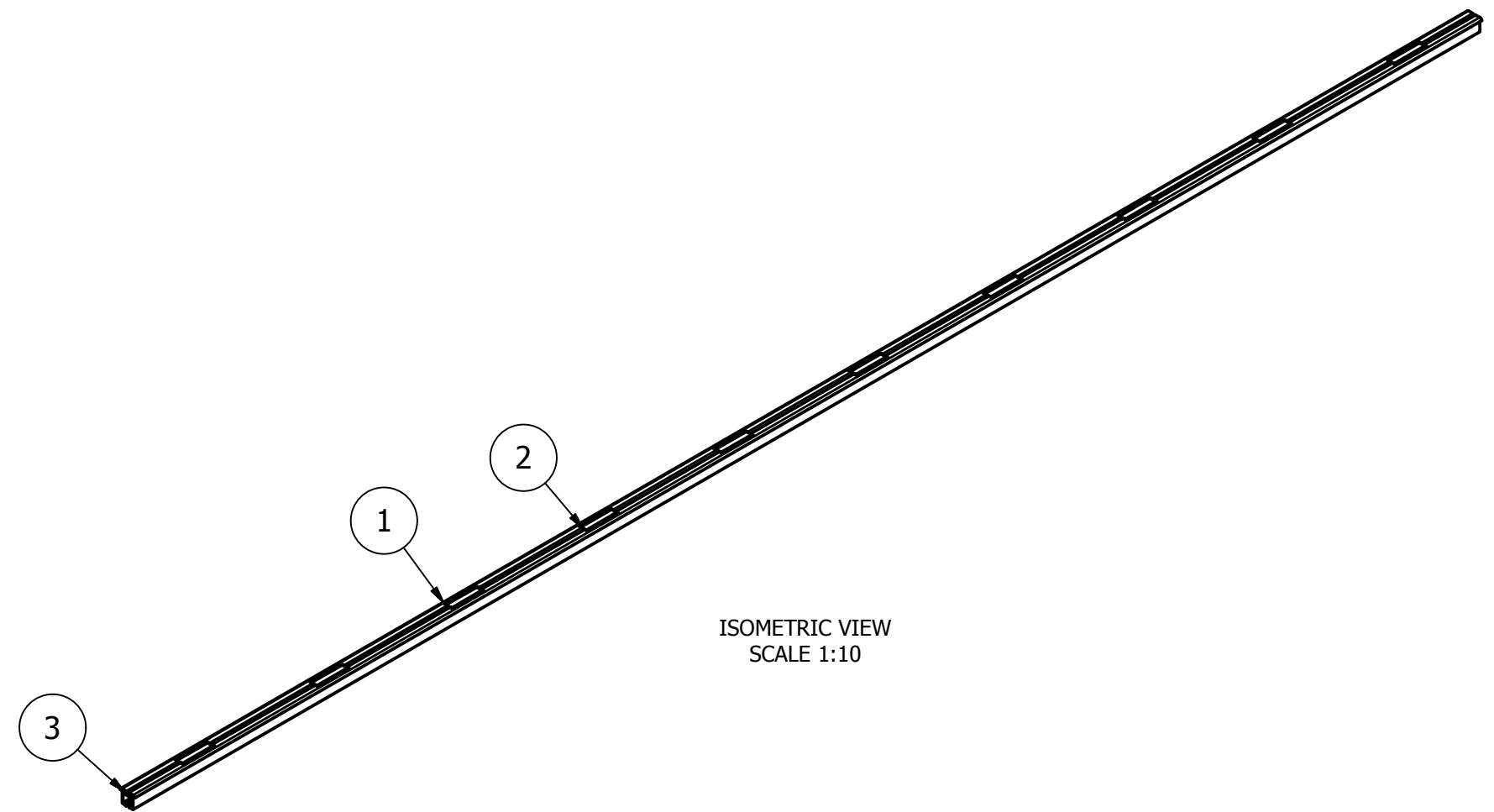

NOTE:  
FINISH - COLOURLESS ANODISED

GENERAL TOLERANCES ON LENGTHS	
0.5 - 6 ± 0.1mm	
6 - 30 ± 0.2mm	
30 - 120 ± 0.3mm	
120 - 400 ± 0.5mm	
400 - 1000 ± 0.8mm	
1000 - 2000 ± 1.2mm	
2000 - 4000 ± 2.0mm	

ALBERT JAGGER LTD  
GREEN LANE  
WALSALL PHONE: 01922 471000  
WEST MIDLANDS FAX: 01922 648021  
WS2 8HG  
  
THIS DRAWING & THE DESIGN SHOWN  
ARE THE PROPERTY OF ALBERT JAGGER LTD  
AND MUST NOT BE USED OR COPIED BY A  
THIRD PARTY WITHOUT PERMISSION

REV	DESCRIPTION	DATE	APPROVED
2	NEW PART No. ASSIGNED. WAS 2227/3000	09/10/18	U.F
1	VALIDATION COMPLETE	13/04/17	A.P

DRAWN BY U.F	CHECKED BY A.P	THIRD ANGLE PROJECTION	SCALE 1 : 1	MATERIAL SEE TABLE	MASS 3.78kg	FINISH SEE NOTE	Date 05/10/2017	ALL DIMS IN MM UNLESS STATED DO NOT SCALE	A3
							DOUBLE KNUCKLED ALUMINIUM HINGE - 3000 O/A		
							0486-7313522		Edition 2