

PART NUMBER	ITEM 1 PLATE (QTY)	ITEM 2 PLATE (QTY)	ITEM 3 SPRING (QTY)	ITEM 4 SPRING (QTY)	ITEM 5 CATCH (QTY)	ITEM 6 ROTOR (QTY)	ITEM 7 AXLE (QTY)	ITEM 8 RIVET (QTY)	ITEM 9 LEVER (QTY)	PART MARKING
33919-01	15669-01 (1)	13777-01 (1)	13779-01 (1)	13778-01 (1)	13376-01 (1)	13378-01 (1)	15415-01 (2)	80609-15 (1) ②	14711-01 (1)	33919

REVISION	ECN	ECN BY	DESCRIPTION
A	PRE-RLSE	LPS 08/05/13	CREATED
B	PRE-RLSE	LPS 08/13/13	ITEM 6 WAS (2) NOW (1), ITEM 7 WAS (1) NOW (2), NOTE 2 REMOVED.
C	PRE-RLSE	LPS 08/16/13	ITEM 9 WAS INCORRECT NUMBER WAS 15669-01 NOW 14711-01
D	PRE-RLSE	HSS 06/30/15	ADDED 2 X Ø7.26 DIM. ADDED NOTE 2. DESC MOVED TO TITLE BLOCK.
1	PRE-RLSE	HSS 07/07/15	PREPARED FOR RELEASE
2	39061	NRD 8/4/15	DELETED; ITEM 10 (WASHER), PROD STATUS LABEL 80609-15 WAS 13942-01 ADDED; NOTE 3

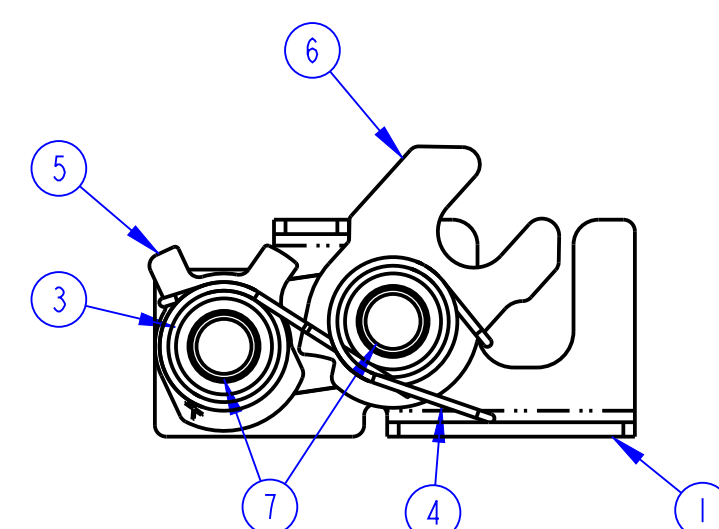

INTERNAL COMPONENTS VIEW ②

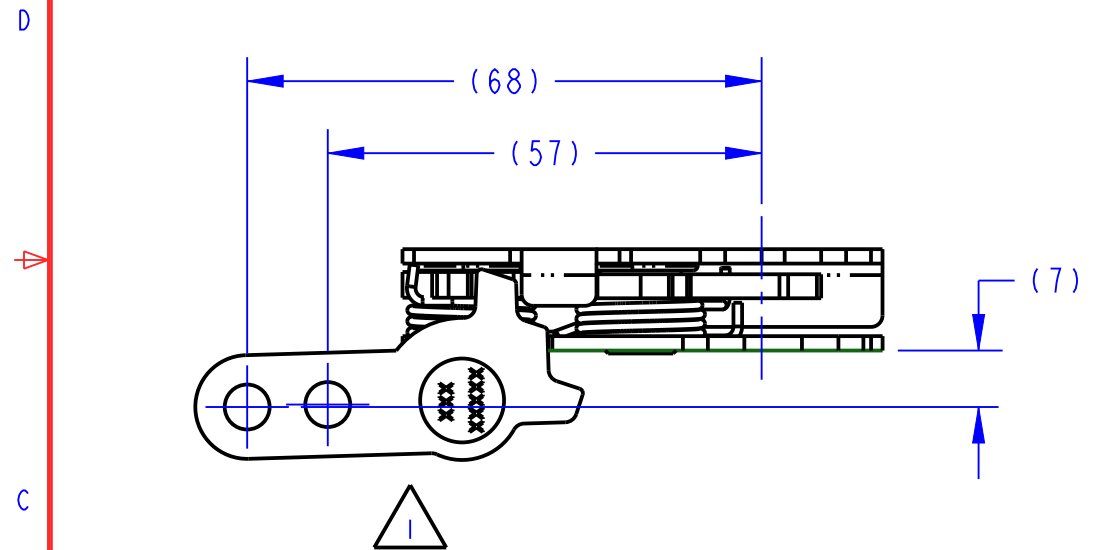
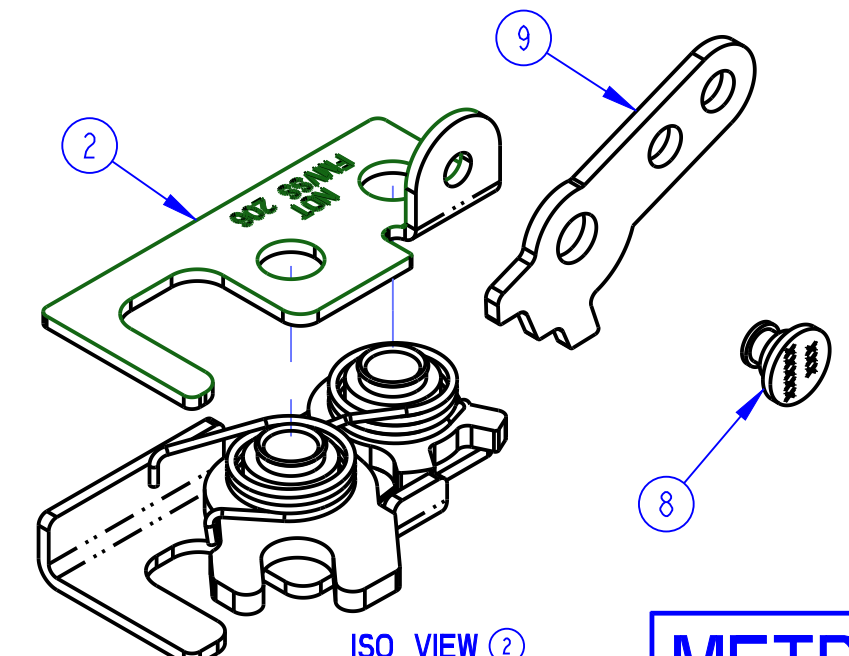
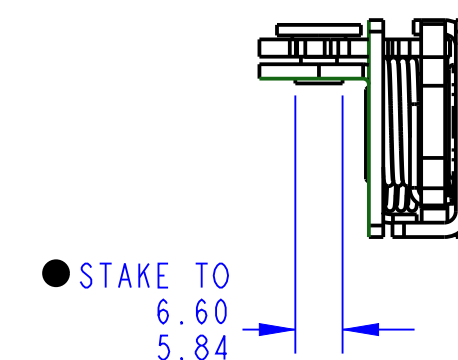
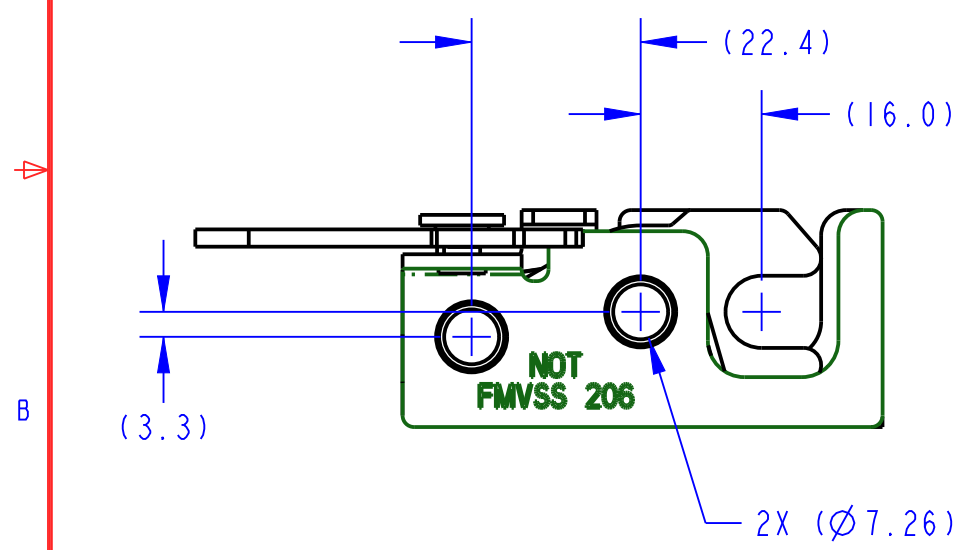

ISO VIEW ②

METRIC

NOTES: UNLESS OTHERWISE SPECIFIED;

① IDENTIFY ASSEMBLIES WITH PART NUMBER AND DATE CODE, APPROXIMATELY AS SHOWN OR IN OTHER APPROVED LOCATIONS AS OUTLINED IN ES-121. ORIENTATION OF RIVET CONTAINING PART NUMBER AND DATE CODE NOT IMPORTANT.

2. USE WITH A 9.53 DIAMETER STRIKER BOLT.

③ 3. OPPOSITE HAND ASSEMBLY IS 29617-01.

<p>● INDICATES REQUIRED ASSEMBLY INFORMATION.</p> <p>UOS: THE -00 VERSION SHALL BE THE UNFINISHED VERSION OF PART SHOWN.</p> <p>UOS: ALL DIMENSIONS APPLY BEFORE COATING. (ASME Y14.5M, sec. 2.4.1)</p>		<p>TriMark[®]</p> <p>500 Bailey Avenue P. O. Box 350 New Hampton, Iowa 50659 U.S.A. Tel: 641-394-3188 Fax: 641-394-2392</p>																																							
<p>TOLERANCES UNLESS OTHERWISE SPECIFIED (UOS)</p> <p>ASME Y14.5M-1994</p> <table border="0"> <tr> <td>INCH</td> <td>MILLIMETER</td> </tr> <tr> <td>X.X = ±.1</td> <td>X = ±.3</td> </tr> <tr> <td>X.XX = ±.03</td> <td>X.X = ±.8</td> </tr> <tr> <td>X.XXX = ±.010</td> <td>X.XX = ±.25</td> </tr> </table> <p>ANGLES</p> <table border="0"> <tr> <td>X°</td> <td>±3°</td> </tr> <tr> <td>X.X°</td> <td>±1.0°</td> </tr> <tr> <td>X.XX°</td> <td>±.50°</td> </tr> </table>		INCH	MILLIMETER	X.X = ±.1	X = ±.3	X.XX = ±.03	X.X = ±.8	X.XXX = ±.010	X.XX = ±.25	X°	±3°	X.X°	±1.0°	X.XX°	±.50°	<table border="1"> <tr> <td>DRAWN BY</td> <td>LPS</td> <td>08/05/13</td> </tr> <tr> <td>CHECKED BY</td> <td>GCL</td> <td>06/30/15</td> </tr> <tr> <td>PROJECT</td> <td colspan="2">13309</td> </tr> <tr> <td>PRODUCT CODE</td> <td colspan="2">E31 (050-0500)</td> </tr> <tr> <td>CUSTOMER</td> <td colspan="2"></td> </tr> <tr> <td>CUSTOMER PART NUMBER</td> <td colspan="2"></td> </tr> <tr> <td>PART WEIGHT</td> <td>SURFACE AREA</td> <td>SIZE</td> </tr> <tr> <td>(94.39 g)</td> <td></td> <td>B</td> </tr> </table>		DRAWN BY	LPS	08/05/13	CHECKED BY	GCL	06/30/15	PROJECT	13309		PRODUCT CODE	E31 (050-0500)		CUSTOMER			CUSTOMER PART NUMBER			PART WEIGHT	SURFACE AREA	SIZE	(94.39 g)		B
INCH	MILLIMETER																																								
X.X = ±.1	X = ±.3																																								
X.XX = ±.03	X.X = ±.8																																								
X.XXX = ±.010	X.XX = ±.25																																								
X°	±3°																																								
X.X°	±1.0°																																								
X.XX°	±.50°																																								
DRAWN BY	LPS	08/05/13																																							
CHECKED BY	GCL	06/30/15																																							
PROJECT	13309																																								
PRODUCT CODE	E31 (050-0500)																																								
CUSTOMER																																									
CUSTOMER PART NUMBER																																									
PART WEIGHT	SURFACE AREA	SIZE																																							
(94.39 g)		B																																							
<p>REF. T/M OP 4.20-2 FOR SUP. QUALITY REQ.</p> <p>REF. T/M OP 4.20-3 FOR INT. QUALITY REQ.</p>		<p>DESCRIPTION</p> <p>050-0500, LH, IPOS, 7.26MM, STR, 2PT</p>																																							
<p>DO NOT SCALE DRAWING</p>		<p>SCALE</p> <p>1.0</p>																																							
<p>PART NUMBER</p> <p>33919</p>		<p>SIZE</p> <p>B</p>																																							